



3  1  1 

Uphill & Schaefer Real Estate
0267721200

10 Mayfield Ave Armidale, NSW
TRANQUILLITY

This weatherboard home is an original 60's style & the tallowwood flooring would polish up beautifully.
Sunny northern verandah, three bedrooms, bathroom separate from toilet, laundry has built-ins.
?L? shaped kitchen, dining, living area with heat bank. Single lock-up garage with power & a cubby house for the kids.
This home is tucked away in a peaceful cul-de-sac

Contact Julie Schaefer
0408 200 668

Type House

Land 793Square Metres

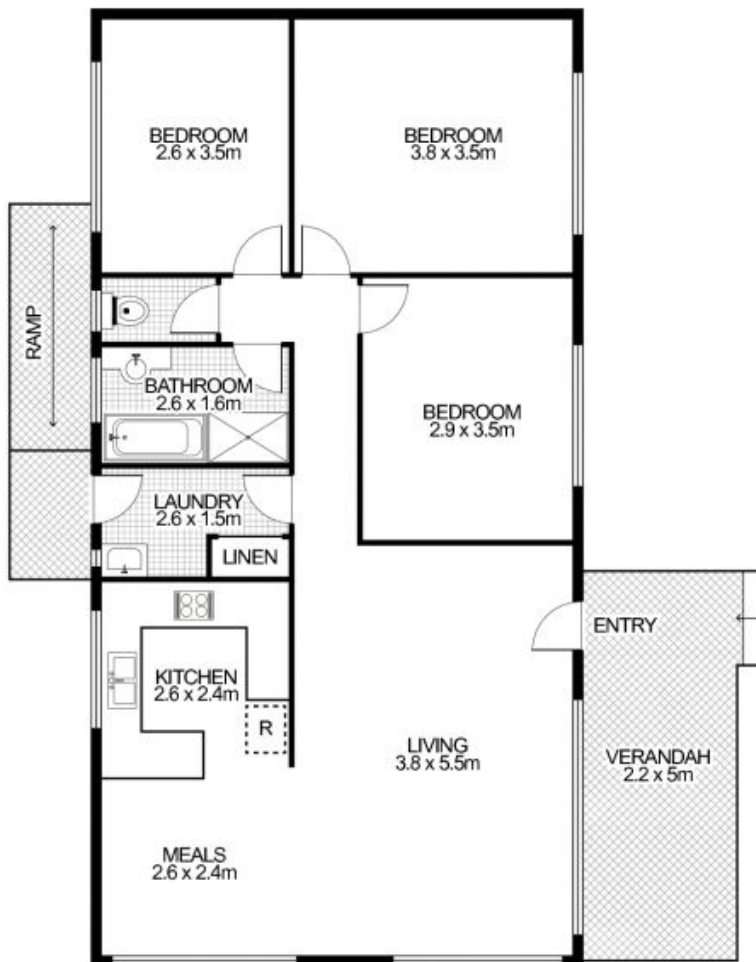
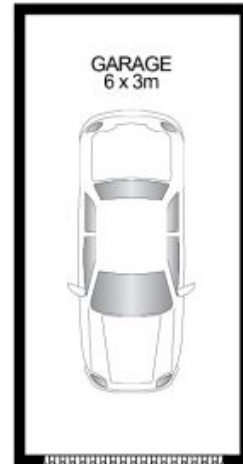

10 Mayfield Avenue, ARMIDALE



This floor plan is intended as a guide only. Layout dimensions are approximate only. No representations or warranties of any nature whatsoever are given or intended. Any person using this information should rely on their own enquiries. Floor Plans by SURROUNDPIX.